

Quartiere GWL, Amsterdam (N) 2003

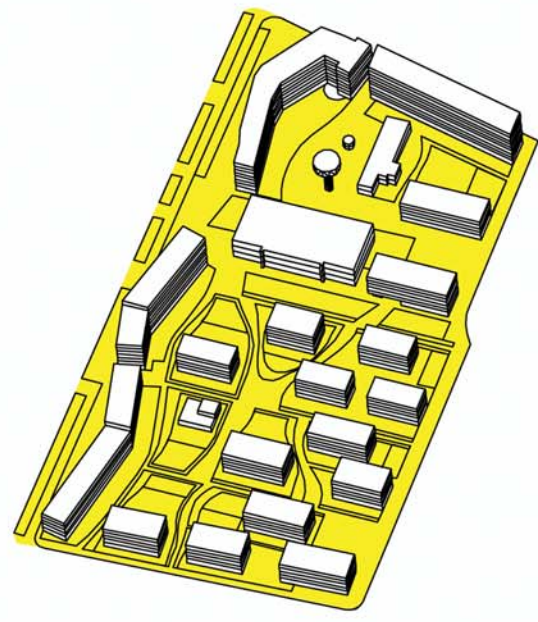

vista sud est

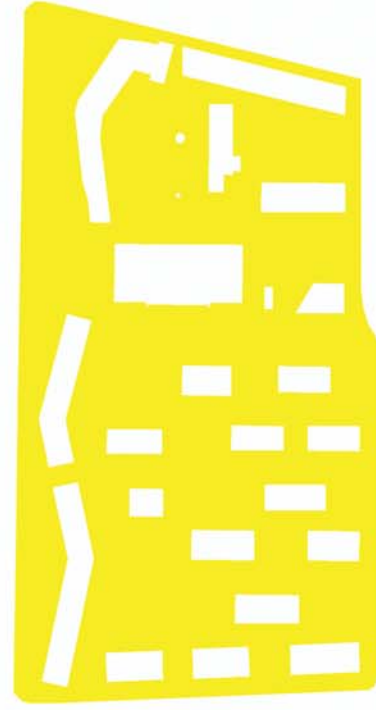

superficie del lotto  
16.937 mq

area non costruita  
74%

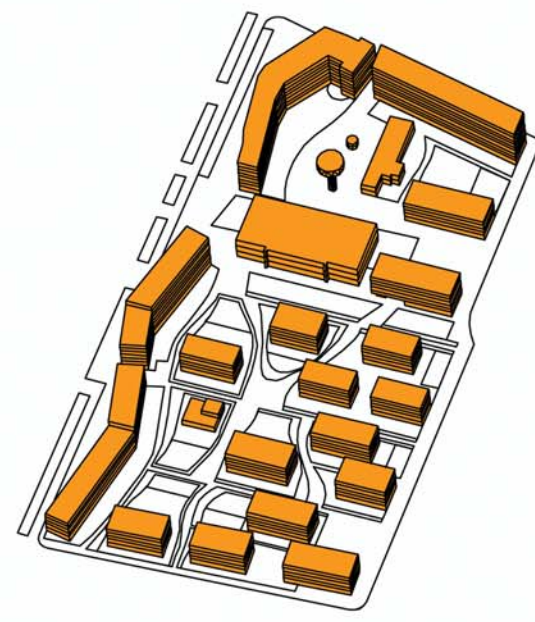

superficie del lotto  
16.937 mq

area costruita  
26%

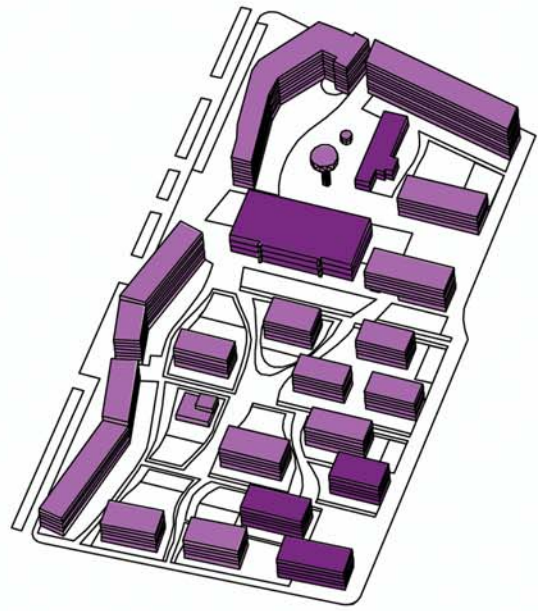

volume totale del costruito  
312180 mc

residenza  
75%

servizi  
25%

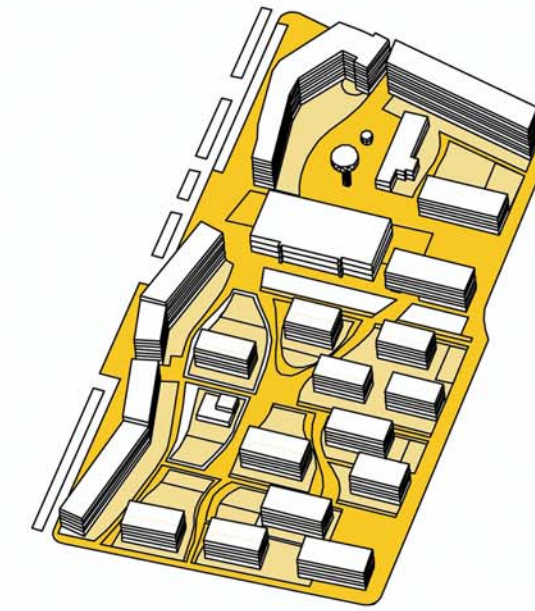

superficie del lotto  
16.937 mq

uso collettivo pubblico  
68%

uso collettivo privato  
30%